

# University of Hertfordshire

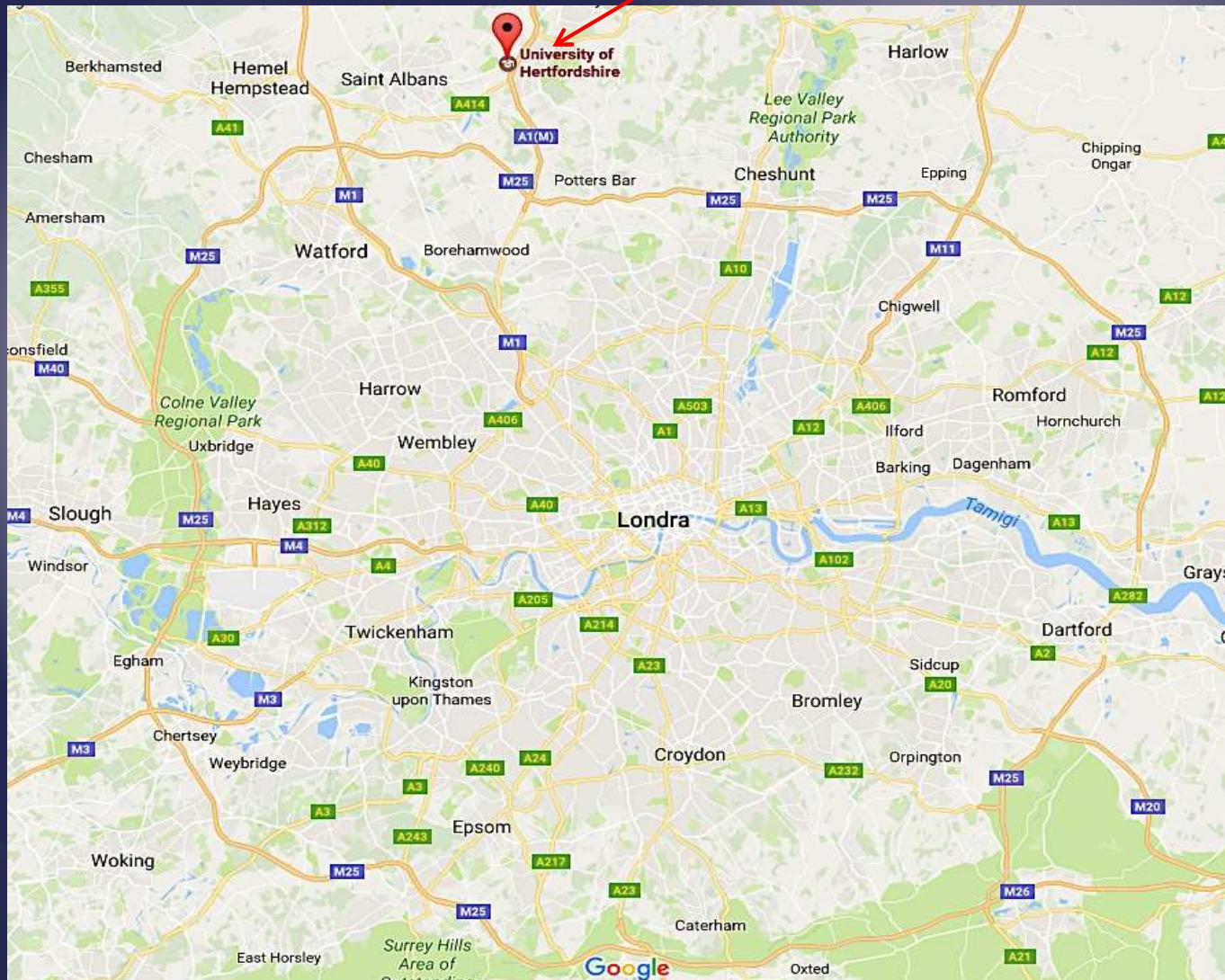

# Dove si trova?

L'università si trova ad Hatfield, a soli 20 minuti di treno dalla stazione di King's Cross.



# Come raggiungerla?

- Roma – Heathrow Airport (per chi arriva ad Heathrow, l'università offre il servizio navetta che porta direttamente al campus dove dovrete fare il check in)
- Roma – Stansted/Gatwick Airport (da qui poi dovete prendere poi il National Express che arriva davanti alla Galleria, mall che dista 5 minuti a piedi da De Havilland Campus, 15 minuti da College Lane Campus)
- Roma – Luton Airport (Luton è l'aeroporto più vicino, quindi da qui potete scegliere se prendere un taxi, uber o un bus che porta ad Hatfield. Di solito se siete un gruppo di persone è più conveniente e comodo prenotare un taxi)



# College Lane Campus



## College Lane Campus

- 1 Mercor Building
- 2 The Oval
- 3 Todd Building
- 4 Art & Design Building
- 5 Film, Music & Media Building
- 6 Broad Hall
- 7 Prince Edward Hall
- 8 Nursery (on Hertfordshire)
- 9 Ebbw Vale
- 10 Hutton Hub
- 11 Main Building
- 12 Science Block
- 13 Health & Safety Office
- 14 Document Services Inwards
- 15 Post Room & Goods Inwards
- 16 Inception Centre
- 17 Automotive Centre
- 18 Vehicle Road Simulation Lab
- 19 Health Research Building
- 20 Wright Building
- 21 The Kiosk
- 22 Yorkshire International College (YIC)
- 23 Yorkton Building
- 24 Learning Resources Centre (Bloxton Centre for Learning)
- 25 John Ullin Music Centre
- 26
- 27
- 28
- 29
- 30
- 31

- A Bellingham Court
  - B The Oval
  - C Telford Court
  - D Broad Hall
  - E Chapman Hall
  - F Fern Hall
  - G Butler Hall
  - H
  - I
- P Accessible parking (blue badge holders)
  - V Visitor parking
  - S Student parking (pay & display)
  - R Student residence parking
  - F Free paying staff parking
- Please note: staff members holding blue badge holders should park in all areas marked above.
- Bus stop
  - Cycle racks (external)
  - Cycle racks (not sheltered)
  - Shower & changing facilities
  - Learning zone

- 25 Accessible parking (blue badge holders)
  - V Visitor parking
  - S Student parking (pay & display)
  - R Student residence parking
  - F Free paying staff parking
- Please note: staff members holding blue badge holders should park in all areas marked above.





# Cosa ci troviamo?

- Main Reception
- Student Centre
- Campus Pharmacy
- LRC (Learning Resource Centre)
- Forum
- Ele House (Pub)
- Starbucks e Subway
- Campus Restaurant
- The Oval
- Innovation Centre
- Arte and Design Gallery
- School of Computer Science
- School of Creative Arts
- School of Engineering and Technology
- School of Health and Social Work
- School of Life and Medical Science
- School of Physics, Astronomy and Mathematics





# De Havilland Campus

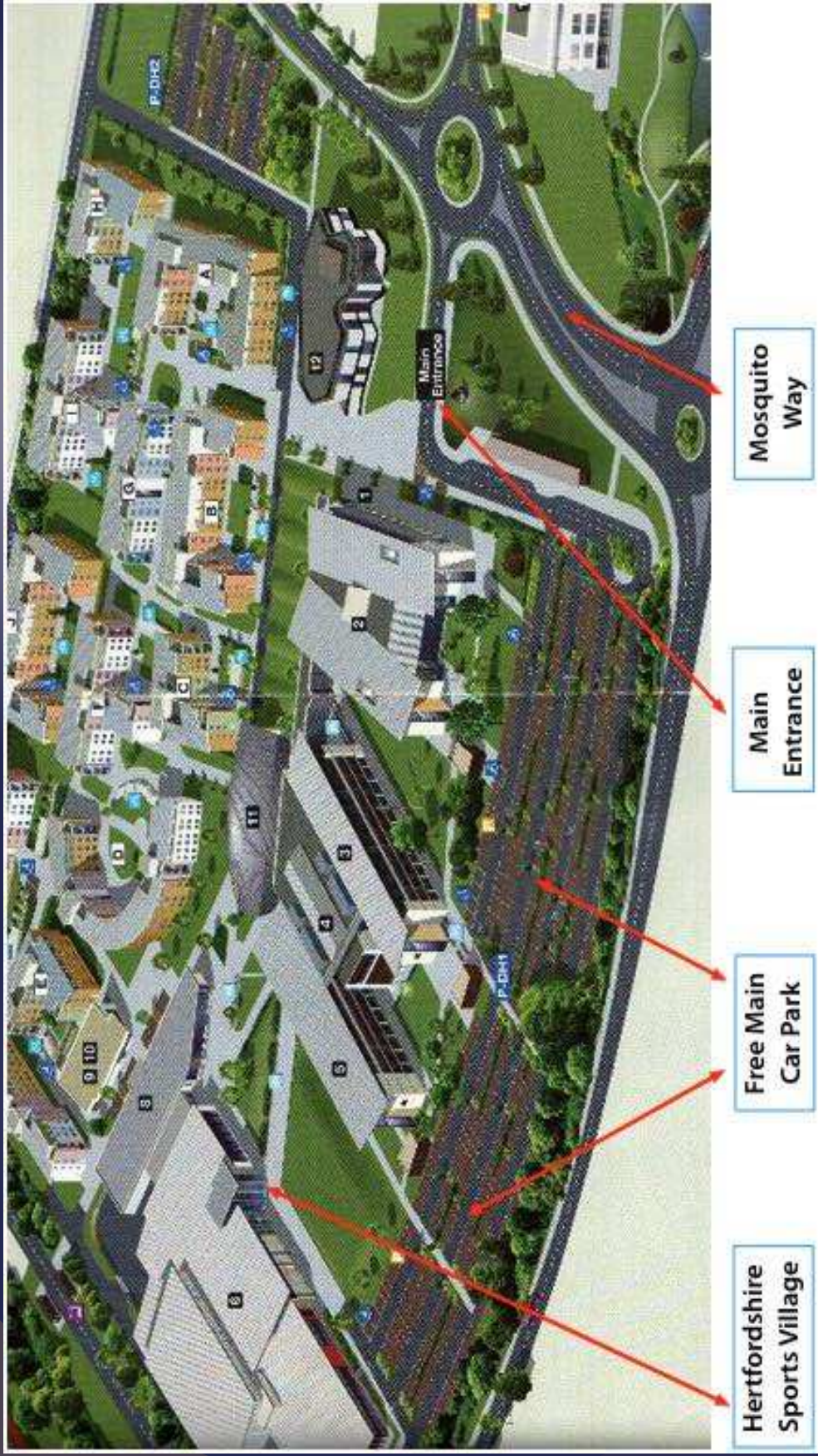



# Cosa ci troviamo?



- Business School
- School of Education
- School of Humanities
- School of Law
- Auditorium
- Sports Village
- Law Court Building
- Club de Havilland
- Accomodation Office
- LRC (Learning Resource Centre)
- De Havilland Restaurant



# University Life

- Divisione semestre, lezioni, esami (business reports, group works, oral presentation)
- Fresher's Week e Buddy Program (due settimane di orientamento, free food, activities, parties)
- CASE (Centre for Academic Skills Enhancement)
- Viaggi organizzati (ESN Card)
- LRC : Biblioteca aperta 24/24 h
- Corso di Academic Business English

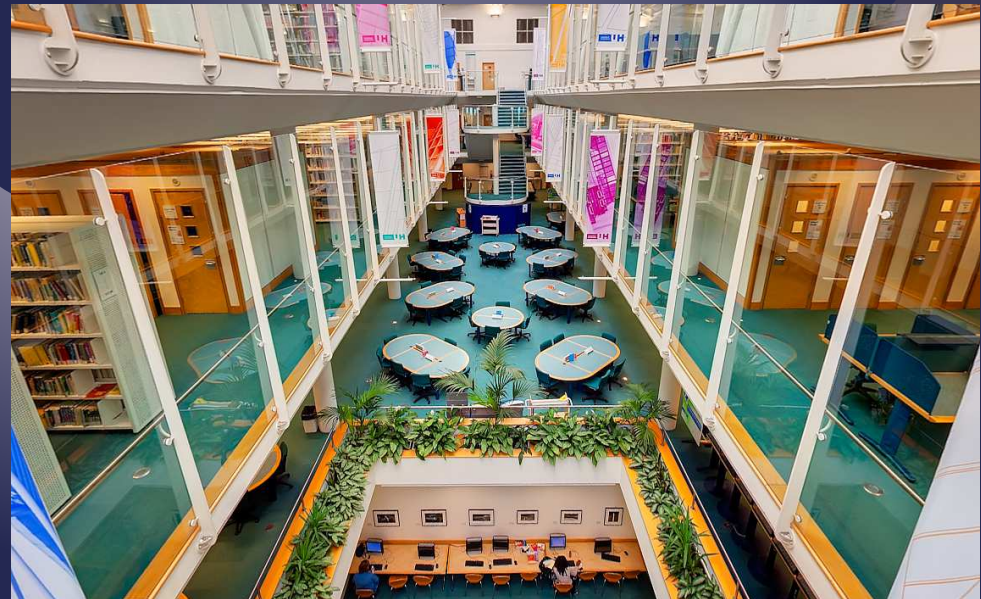



# Student Life

- Hertfordshire Sport Village – 3 diverse memberships (Gold, Silver, Bronze)
- Dove fare la spesa? Due supermercati (ALDI e ASDA)
- Cosa fare la sera? Pubs, Ristoranti, Discoteche (Forum: Cheeky Wednesday/Contrast)
- Weekends a Londra (Biglietti Scontati per gruppi)
- Scheda Telefono con contratto mensile (giffgaff)
- Trasporti
- Info Generali (costo della vita)



# Lo sapevate che...

- Hertfordshire è il posto in cui è stato ambientato il romanzo "Pride and Prejudice" di Jane Austen





# Buon Erasmus!

Per Informazioni:

Cecilia Mazzarotto (Bachelor in Business Administration)

*[ceci.mazzarotto@tiscali.it](mailto:ceci.mazzarotto@tiscali.it)*